

Item No. : **1811435-0**

Installation guide

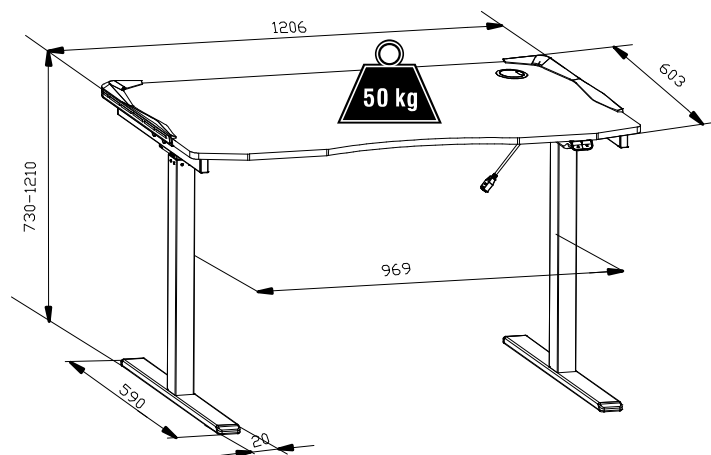

Technical data

Column Stage	2
Average Speed	25mm/s
Input voltage	100-240V
Duty Cycle	10%(Work continuously for 2 minutes, pause for 18 minutes)
Temperature	0~40°C

Accessory list

Attention: The drawings below are only for reference which might be slightly different from the actual object, please in kind prevail. Any tools missing or installation problems, please contact the customer service firstly.

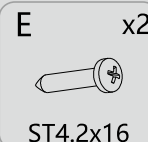
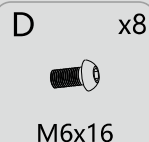
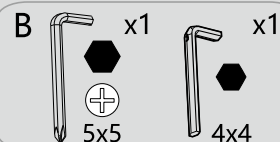
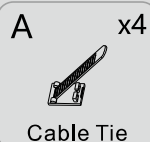

Component List

No.	Part	Qty	No.	Part	Qty
①	Tabletop	1	②	Lifting Column	2
③	Feet	2	④	Handset	1
⑤	Headphone hook	1	⑥	Switch Cord	1
⑦	Power plug	1	⑧	Remote Control	1
⑨	USB Cable	1	⑩	Handset Hook	2
⑪	Handset Supporting frame	1	⑫	Handset Base	1

Installation Diagram

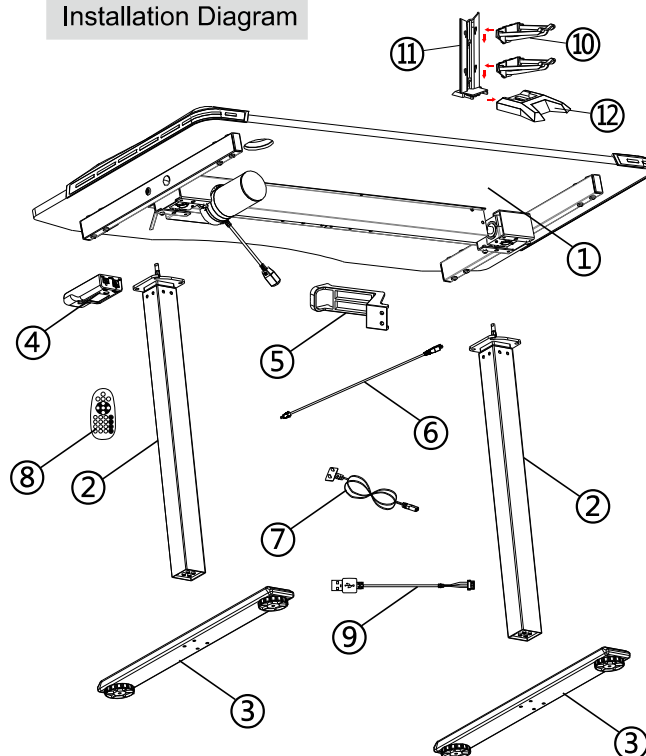

STEP1

Install Handset

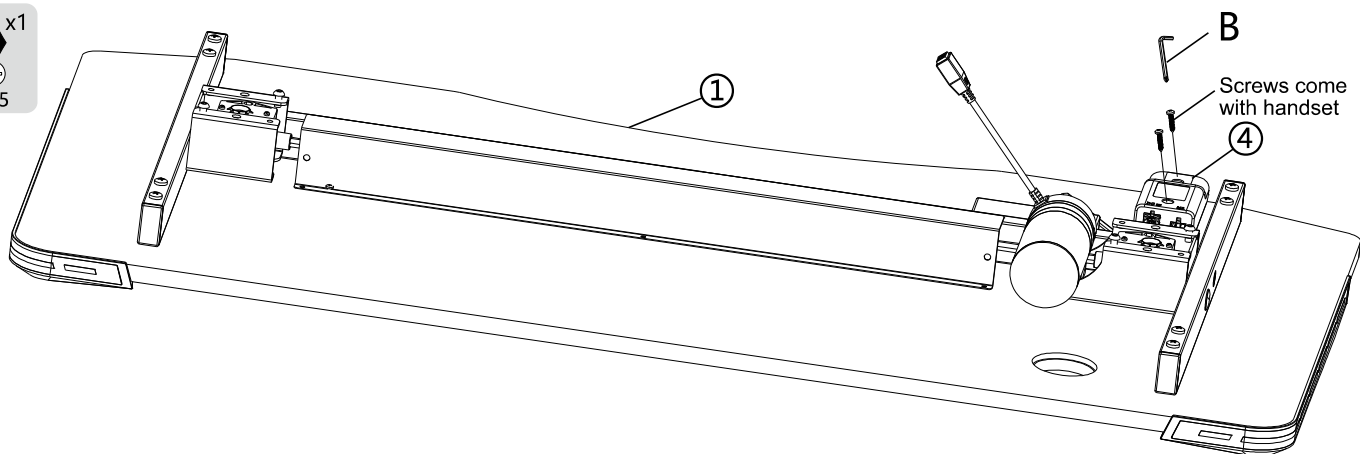
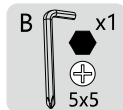

STEP2

Install Lifting Columns

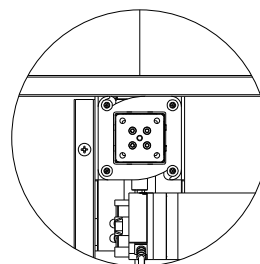
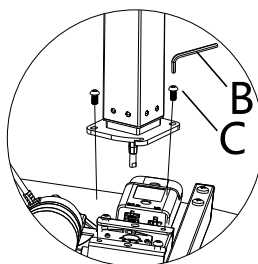
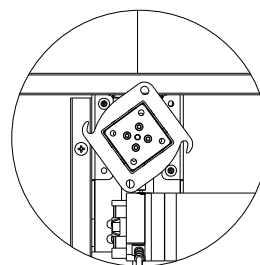
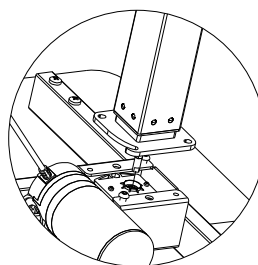
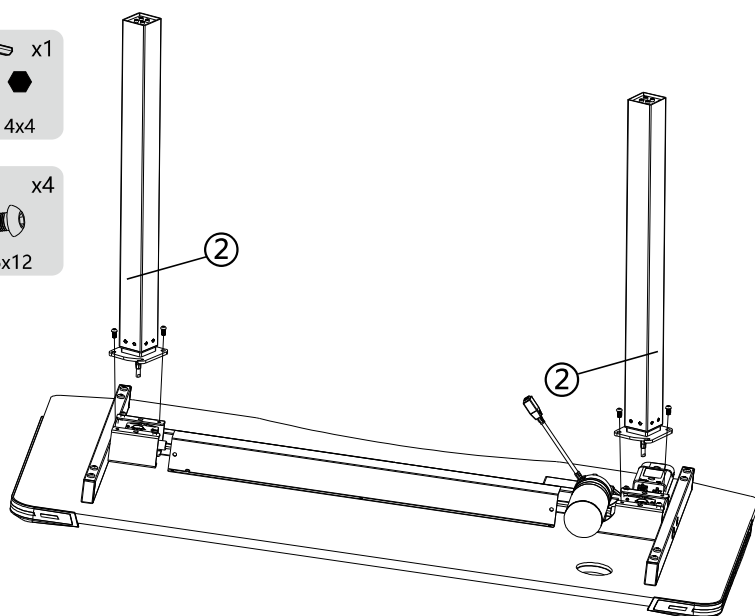
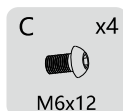
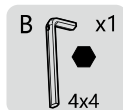

STEP3

Install feet

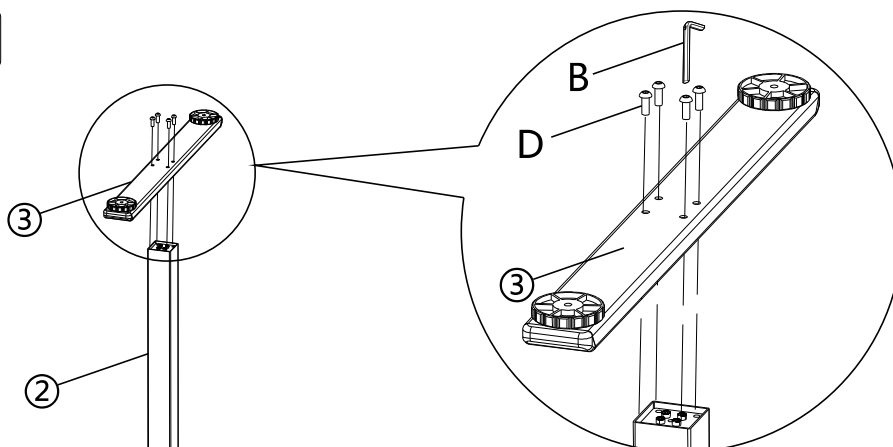
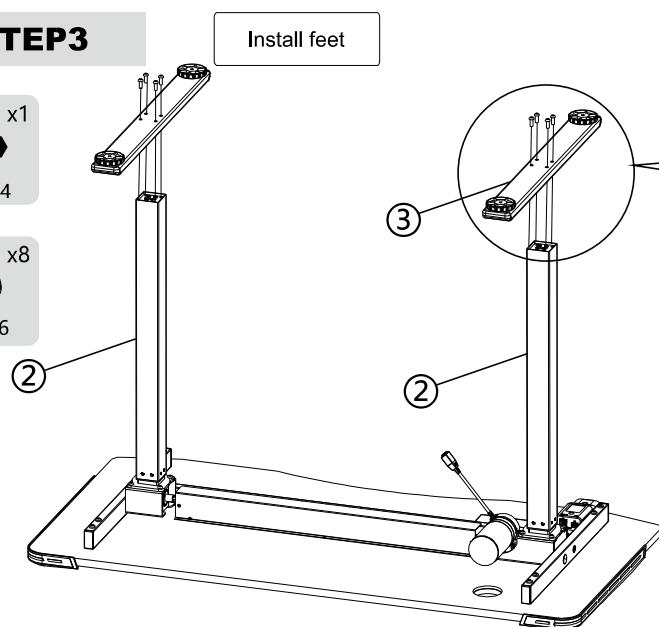
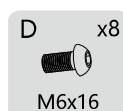
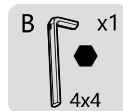

STEP4

Wire All Cables

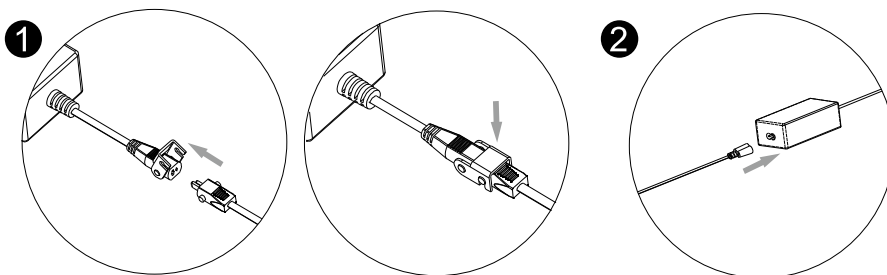
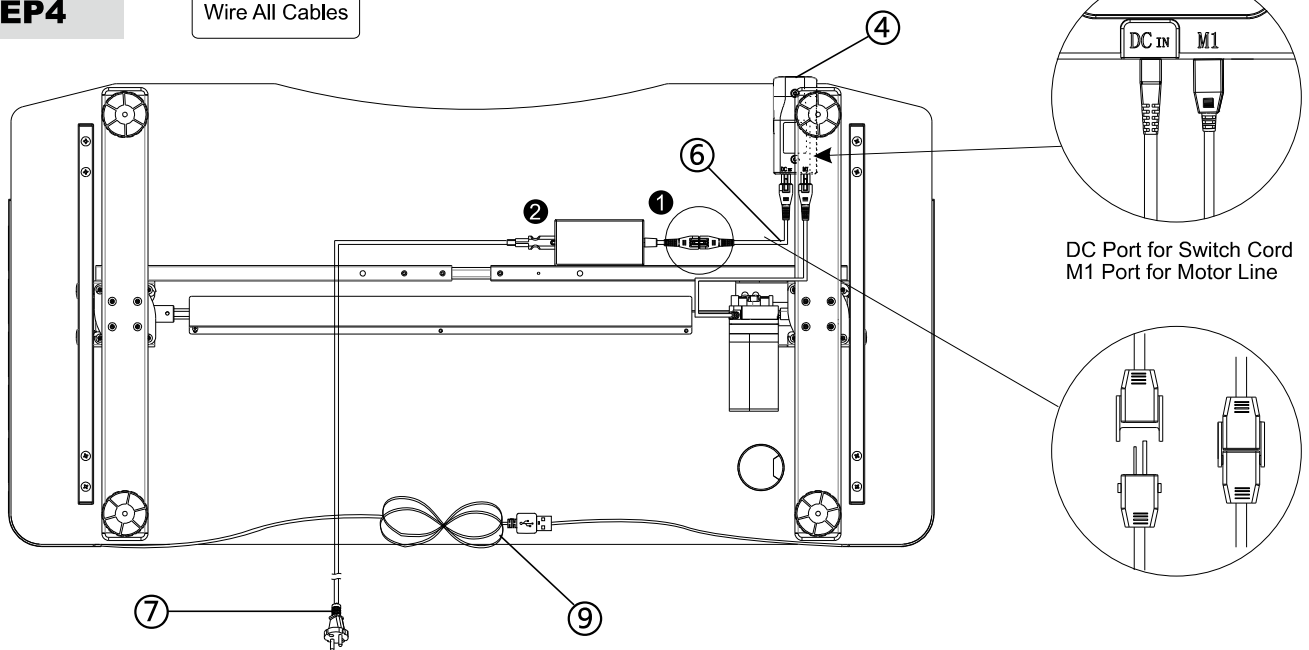

Connect the ⑥, motor line, ④, ⑦, ⑨ and adapter, and fix them to the appropriate position under the table with the (A).

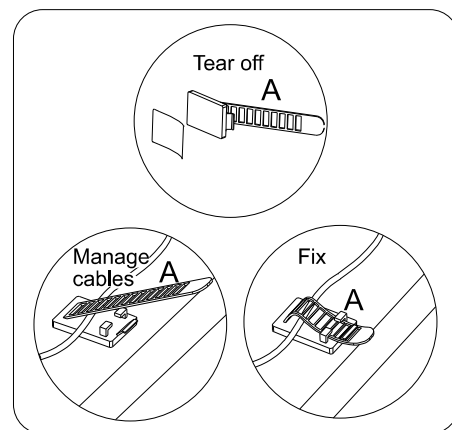

STEP5

Install accessories

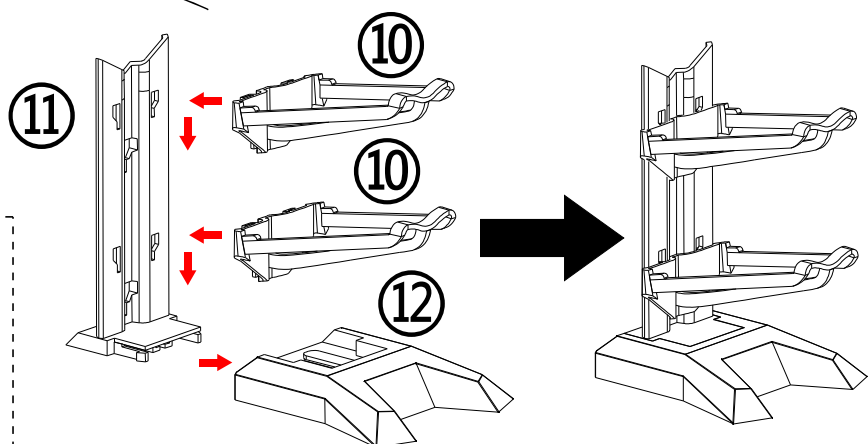
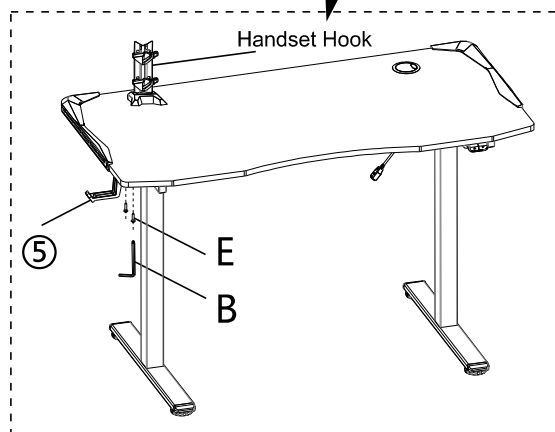
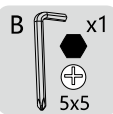

How to use handswitch

●	“▲”	Adjust the desk upwards
●	“▼”	Adjust the desk downwards

Instruction

- **Lifting Function**
press the “▲” or “▼” button to increase or decrease the height
- **Reset Function**
(1) Hold the “▼” button for more than 5 seconds to enter reset mode when at the lowest position. The reset is not completed until the lifting system reaches the bottom, then rebounds to stop.
(2) When the lifting system fails, release the button and long press the “▼” button. The reset is not completed until the lifting system reaches the bottom, then rebounds to stop.
- **Remote Pairing**
Connect the light strip and the USB connecting cable. Hold the “ON” button before the light strip is powered on. After connecting to the power supply (Input Voltage: DC5V), keep pressing the “ON” button until the light strip stops flashing, and the pairing is successful.

Common fault treatment

The following tips will help you detected and eliminate the common fault and error. If the fault you met is not listed below, please contact with your supplier. Only the manufacturer and professionals are capable for investigating and correcting those fault and error.

Fault phenomenon	Method
The desktop could not function	Check if all the cables well connected;
Rising in a low speed	Check if overloaded, max loading: 50kg;
The desk moving downwards without any operation	
Automatically Self-Reset	
Go down but not go up or go up but not go down	Reset;
The upper and downward height is not enough	
The desk could not lifted	
Overwork (Duty cycle: Max 2min on/18min OFF)	Restart after suspend for 18mins while connecting with power.
The light strip cannot be controlled by remote	1. Replace the remote control battery
	2. Perform remote pairing operation steps
The light strip does not light up	1. Check whether the connection between the USB connecting cable and the light strips on both sides is normal
	2. Check whether the connection between the USB connecting cable and the power supply is normal

Remote Control

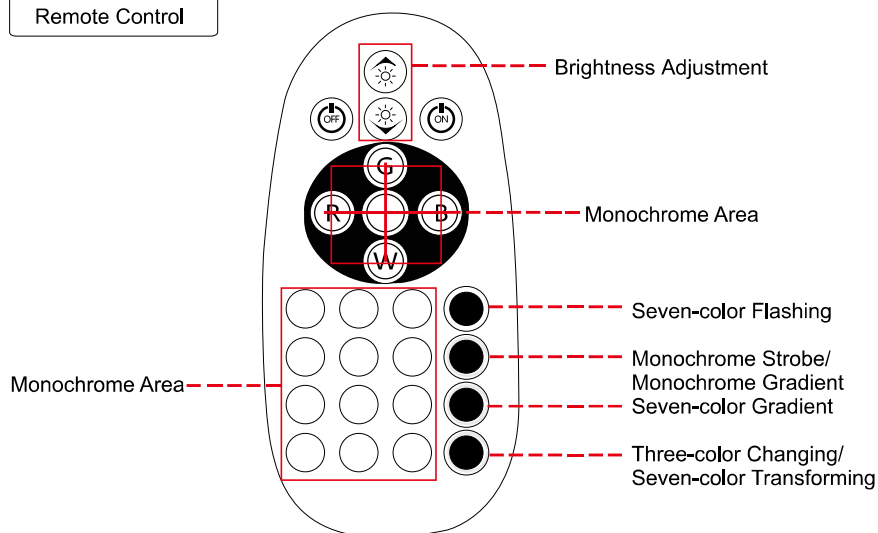

Button

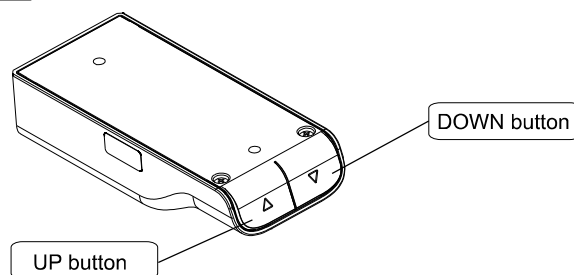

Attention

1. Power supply: AC100V-240V, 50/60Hz
2. Service Environment: 0-40℃
3. Unplug the power plug before cleaning, wipe the dust on surface with slight wet dishcloth when cleaning, be careful not to let the drops into the internal parts, not loose the connector.
4. The electric box contains electronic components, metals, plastics, wires etc., so dispose of it in accordance with each country's environmental legislation, not the general household waste.
5. Check carefully to ensure correct and complete assembly before using.
6. Be familiar with all functions and program settings of the product before first use.
7. Children are forbidden to play on the product because of unforeseen action when playing, so any dangerous consequences caused by this improper action will not be on manufacturers.
8. Slight noise caused by the V-ribbed belt or brake system due to structure will not have any effect on the use of the equipment.
9. Corrosive or abrasive materials are forbidden to clean the equipment. Must ensure that the cleaner used will not pollute the environment.
10. Please make sure there is no hazard sources in your operating environment, e.g., do not litter the tools around. Always be careful to treat the packaging materials in order to avoid any possible danger, e.g. plastic bag may lead to choking hazard to children.
11. Keep the original package of the equipment if necessary in case of the future use in transportation.

Waste disposal

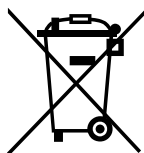

This marking indicates that this product should not be disposed with other household wastes. To prevent possible harm to the environment or human health from uncontrolled waste disposal, recycle it responsibly to promote the sustainable reuse of material resources. To return your used device, please use the return and collection systems or contact the retailer where the product was purchased. They can take this product for environmental safe recycling.